

PLANTA BAIXA
ESC. 1:150

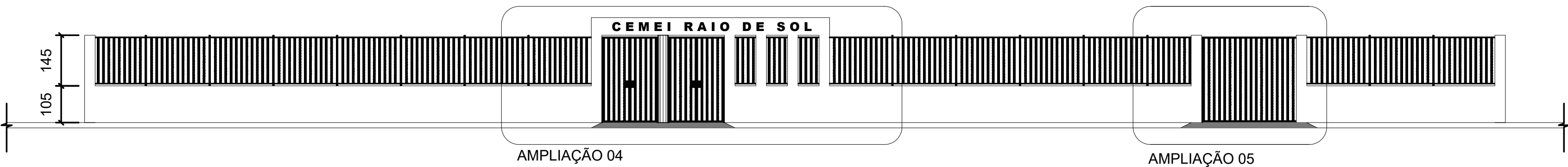

FACHADA
ESC. 1:100

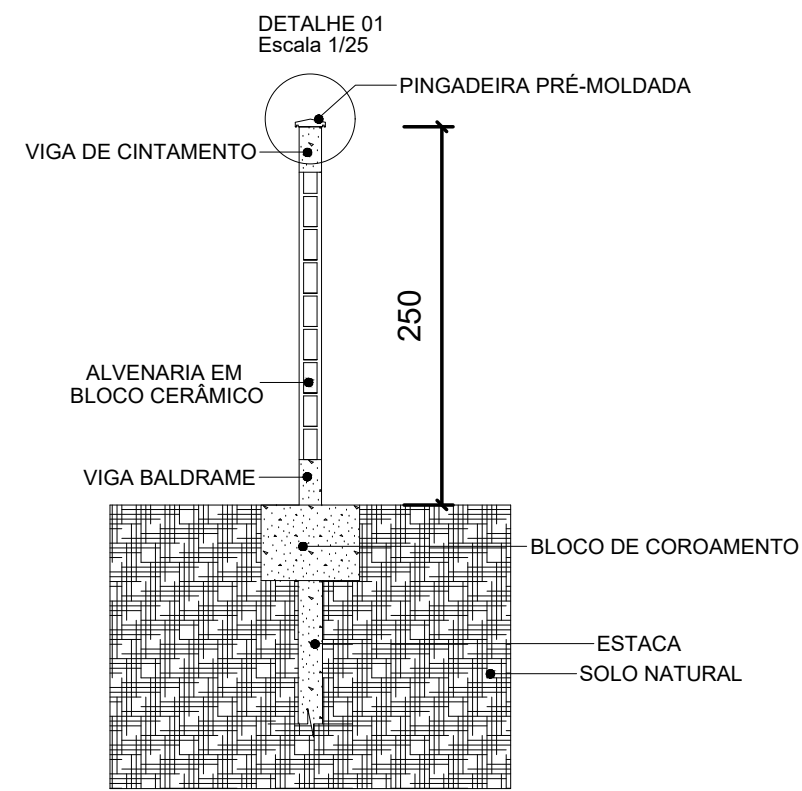

CORTE TRANSVERSAL AA
ESC. 1:50

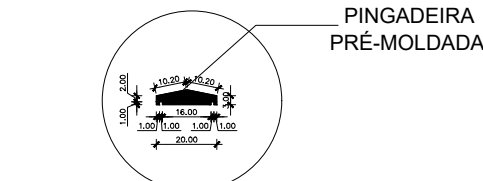

DETALHE 01
ESC. 1:25

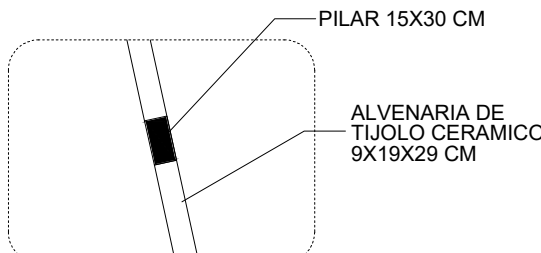

AMPLIAÇÃO 01
ESC. 1:50

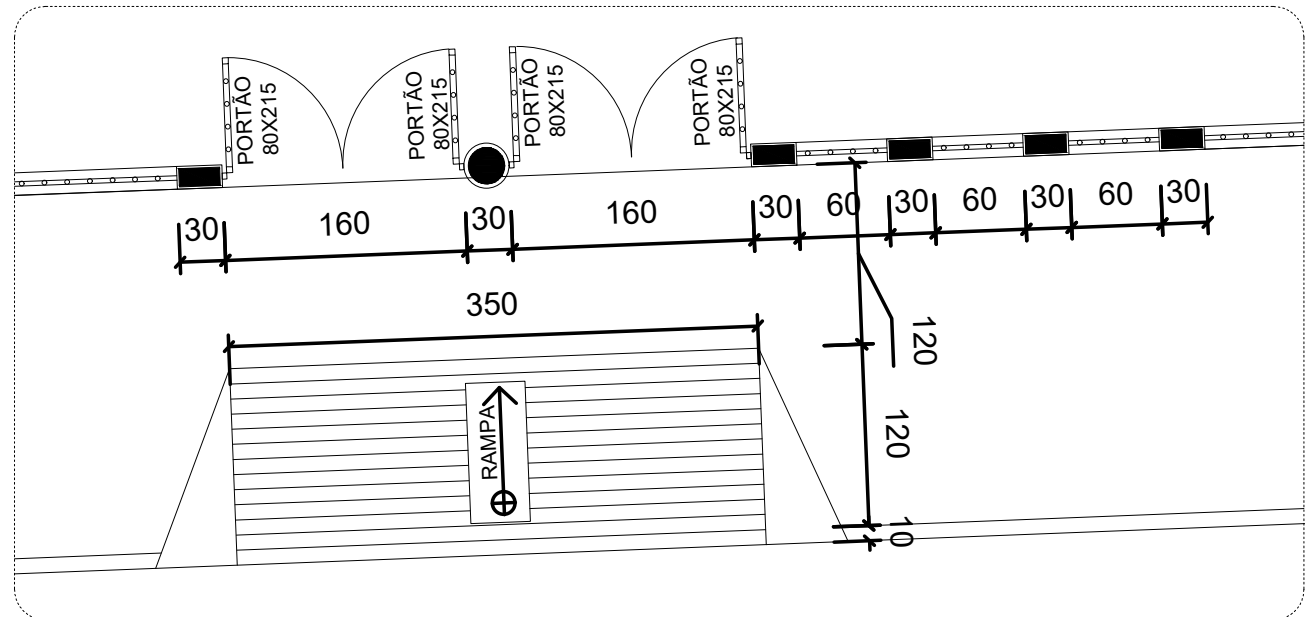

AMPLIAÇÃO 02
ESC. 1:50

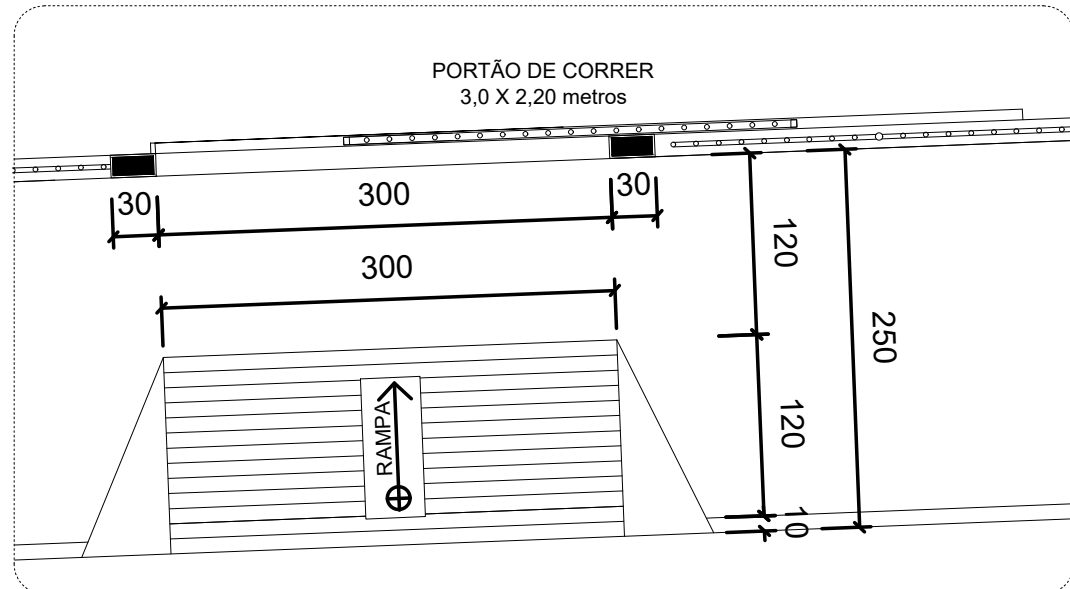

AMPLIAÇÃO 03
ESC. 1:50

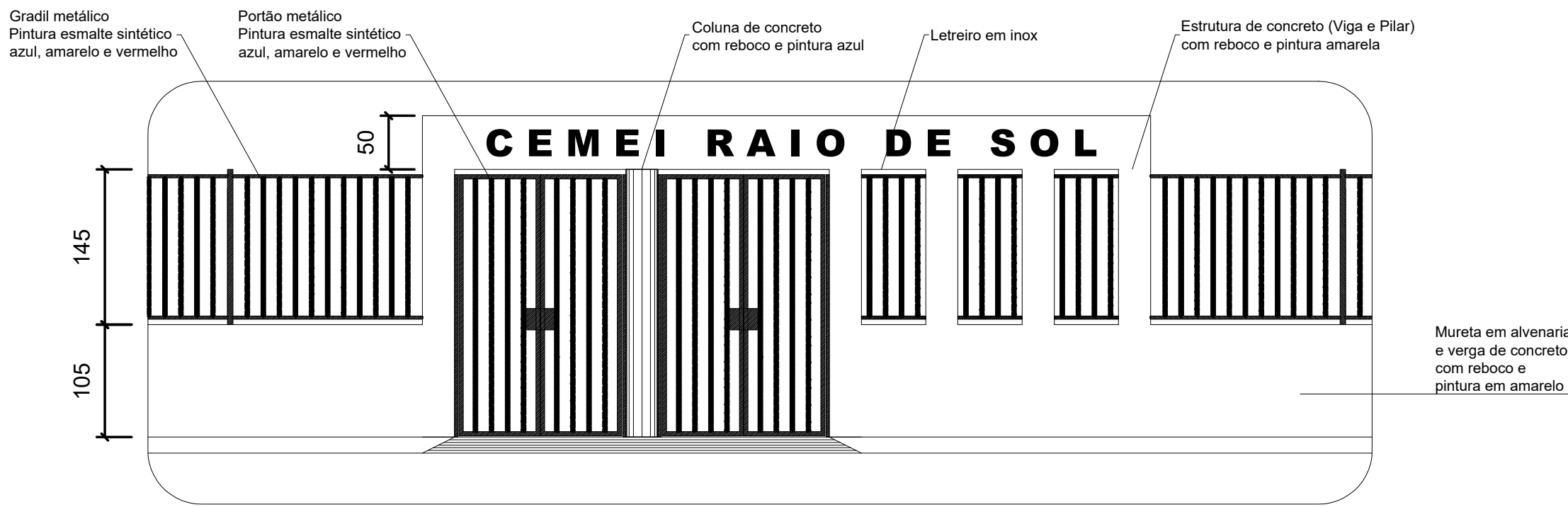

AMPLIAÇÃO 04
ESC. 1:50

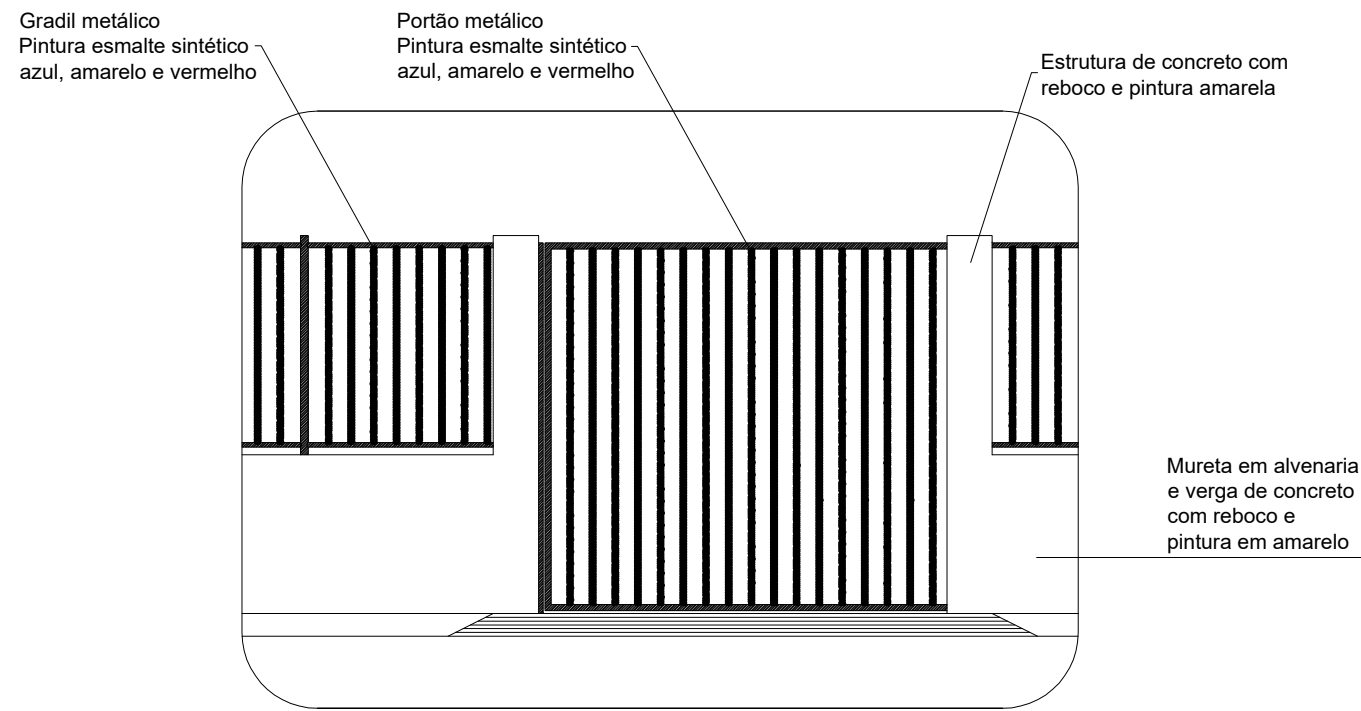

AMPLIAÇÃO 05
ESC. 1:50

PREFEITURA MUNICIPAL DE SÃO FRANCISCO			
TÍTULO: PROJETO ARQUITETÔNICO PROJETO MURO DE DIVISA PLANTA DE LOCAÇÃO, FACHADA, CORTE E DETALHAMENTOS	ENDEREÇO: RUA FRANCISCO LACERDA 2601, SÃO LUCAS; SÃO FRANCISCO - MG		
	ÁREA DO PROJETO:	207,15 m²	PRANCHA:
	AUTOR DO PROJETO:	INDICADA DATA: SET/2022	01/01
TIAGO RIBEIRO ALMEIDA CREA-MG 245.741/D		COORDENADAS: 15°58'11.00"S 44°52'13.50"O	